

DUPLIN 1-4

PROJECT REFERENCE NO. 2024CPT.03.02.10311, ETC.	SHEET NO. 1
--	----------------

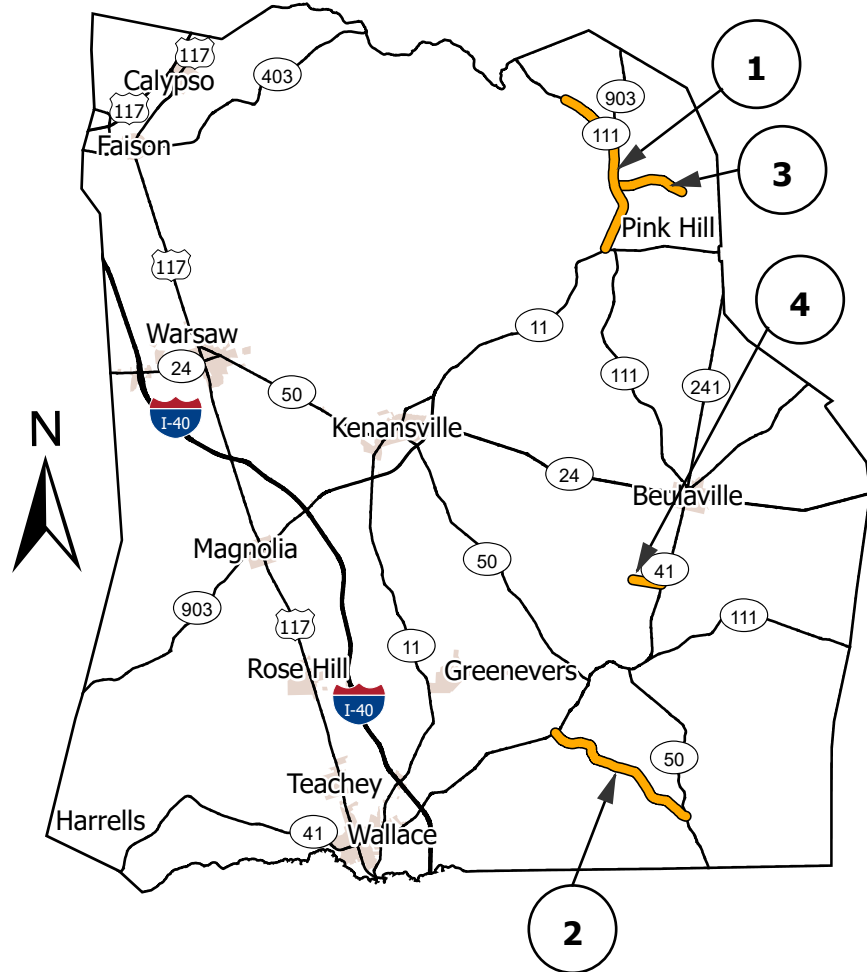

- Resurfacing Maps
- Division 3 Bridges

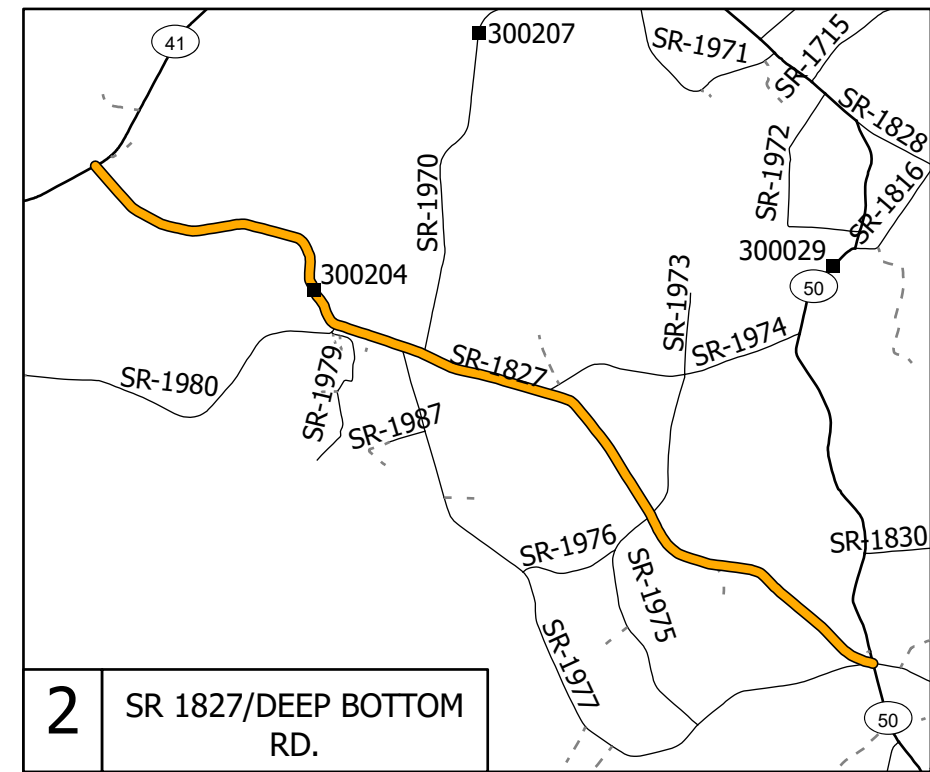
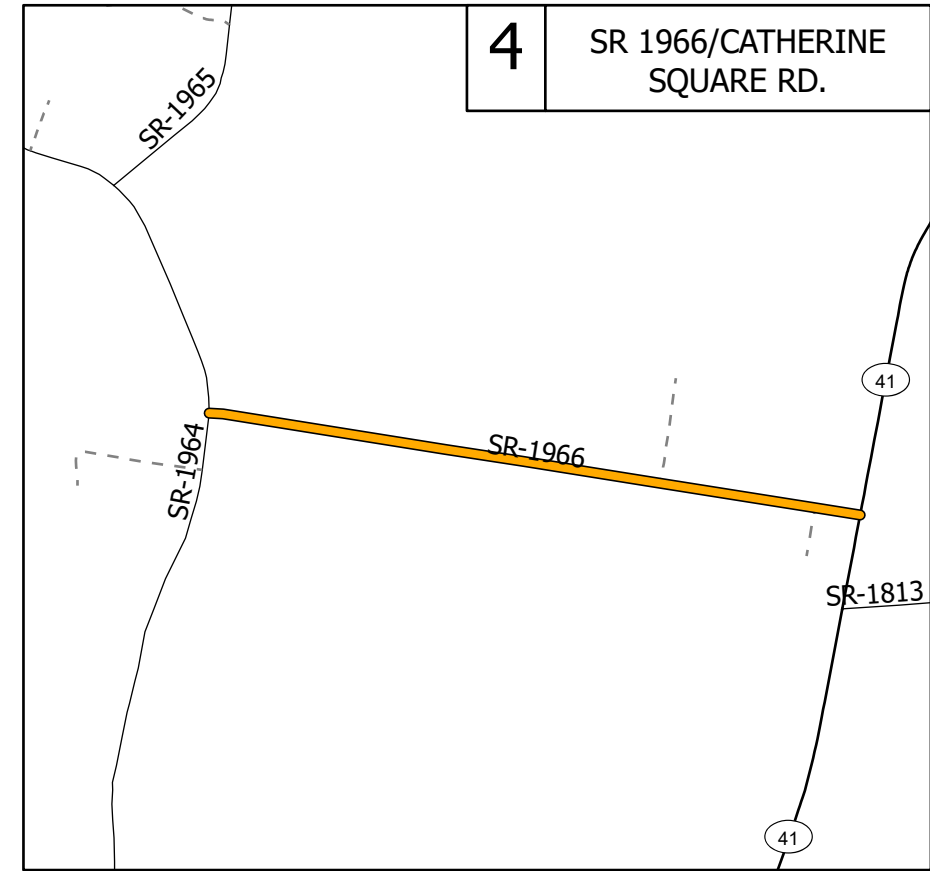
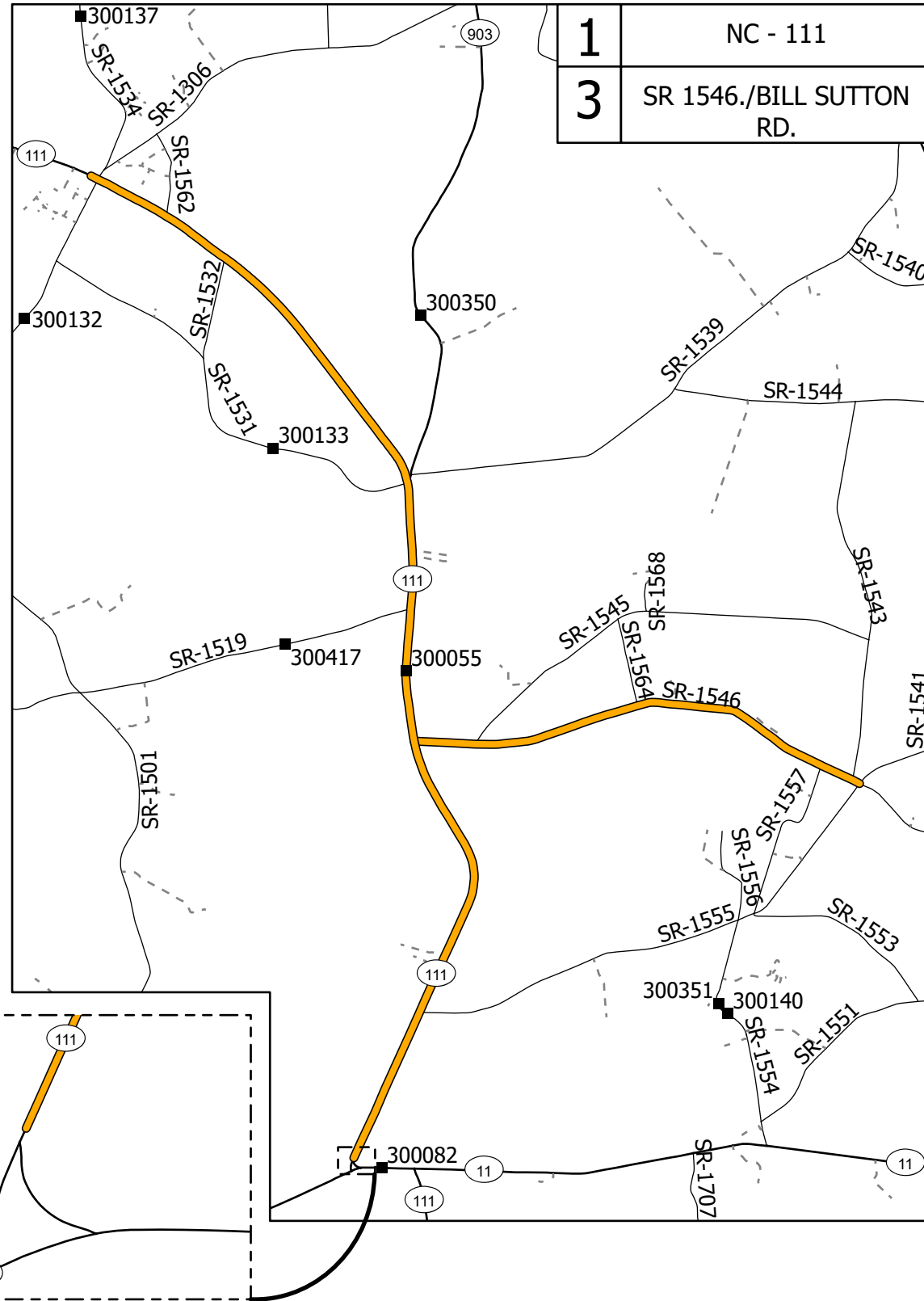

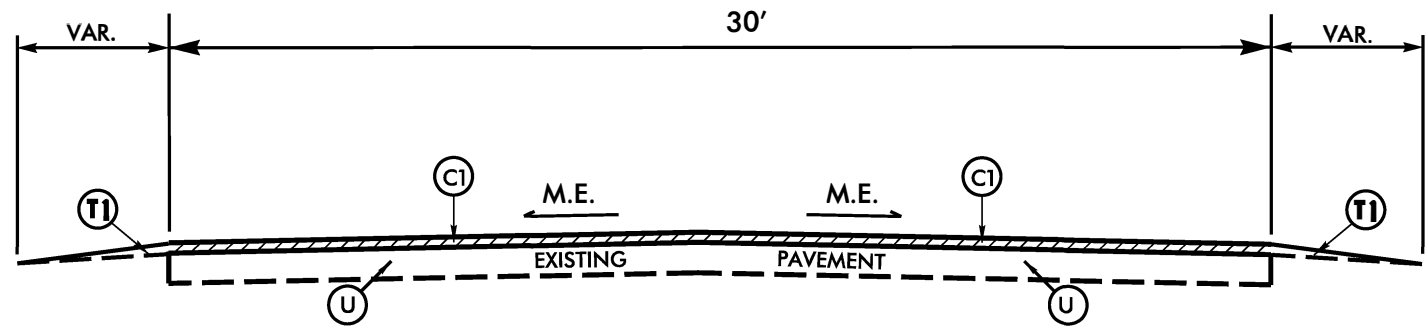

TYPICAL SECTION NO. 1

MAP NO. 1
 NC 111 HWY.
 MP 25.74 – MP 32.44
 ALSO SEE TYPICAL NO. 2

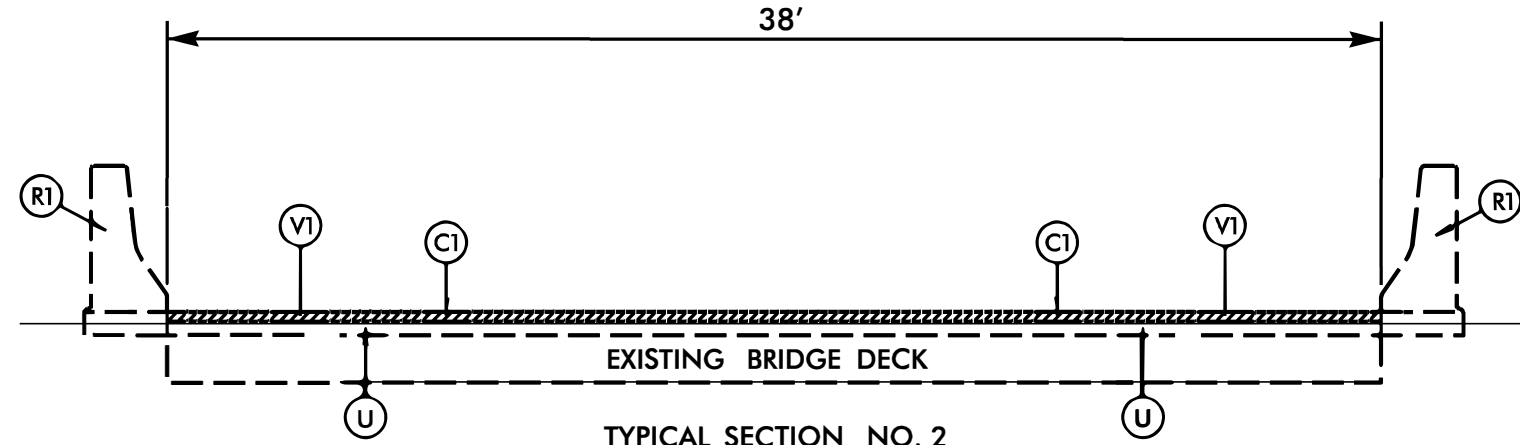

TYPICAL SECTION NO. 2

MAP NO. 1
 NC 111 HWY,
 BRIDGE NO. 055
 MP 28.79 – MP 28.82

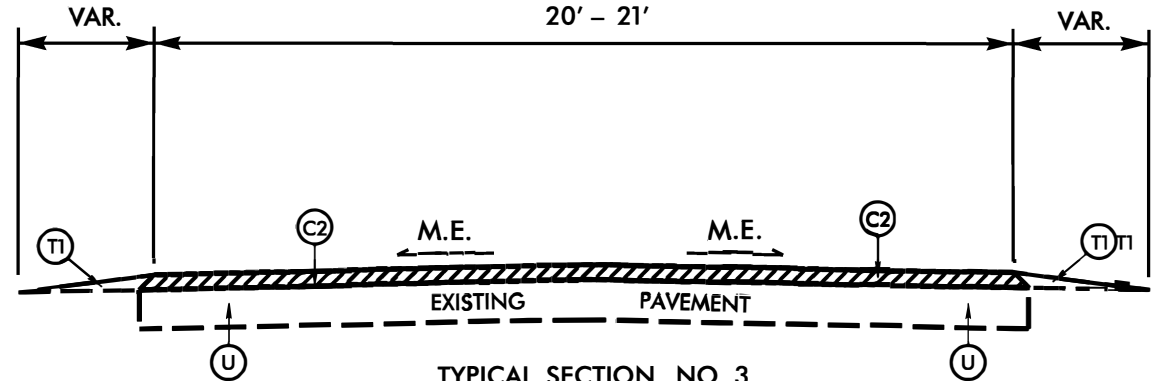

TYPICAL SECTION NO. 3

MAP NO. 2
 SR 1827 (DEEP BOTTOM RD.)
 MP 10.69 – MP 12.46
 NO ASPHALT WORK
 ON DUPLIN BRIDGE NO. 204
 MP 10.63 – MP 10.69

MAP NO. 3
 SR 1546 (BILL SUTTON RD.)
 MP 0.00 – MP 2.68

MAP NO. 4
 SR 1966 (CATHERINE SQUARE RD.)
 MP 0.00 – MP 1.09

(V1) FRIS MILL 1 – 1/2"
 MP 10.69 – MP 12.46

PAVEMENT SCHEDULE	
C1	PROP. APPROX. 1 1/2" DEPTH ASPHALT CONCRETE SURFACE COURSE, TYPE S9.5C, AT AN AVERAGE RATE OF 168 LBS. PER SQ.YD.
C2	PROP. APPROX. 1 1/2" DEPTH ASPHALT CONCRETE SURFACE COURSE, TYPE S9.5B, AT AN AVERAGE RATE OF 165 LBS. PER SQ.YD.
R1	EXISTING CONCRETE BRIDGE RAIL
T1	EARTH MATERIAL (SHOULDER RECONSTRUCTION)
U	EXISTING PAVEMENT
V1	MILLING ASPHALT PAVEMENT, 1 1/2" DEPTH

NOTES: MILL A SINGLE LANE AND PAVE BACK BY THE END OF EACH WORK DAY.

SHOULDER WORK ON MAP NO. 1 – 4 AS NEEDED, TO BE DETERMINED BY ENGINEER.

PAVEMENT EDGE SLOPES ARE 1:1, EXCEPT FINAL SURFACE COURSE. SEE SHOULDER WEDGE DETAIL.

STD.NO.	TITLE
2018 ROADWAY ENGLISH STANDARD DRAWINGS	
The following Roadway Standards as appear in "Roadway Standard Drawings" Highway Design Branch – N. C. Department of Transportation – Raleigh, N. C., Dated January, 2018 are applicable to this project and by reference hereby are considered a part of these plans:	
DIVISION 8 – INCIDENTALS	
862.01	Guardrail Placement
862.02	Guardrail Installation
DIVISION 12 – PVMT MARKING, MARKERS AND DELINEATION	
1205.08	Pavement Markings – Symbols & Word Messages

EFF. 01-16-2018
 REV.

REVISIONS

8/17/95
 SYSTEMS DESIGN
 CONSULTING

DETAILS OF REPAIRING EXISTING PAVEMENT PRIOR TO RESURFACING FOR FULL DEPTH AND MILLING

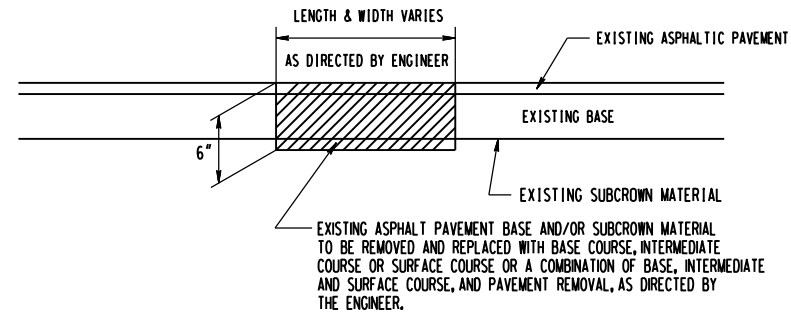

DETAIL NO. 1

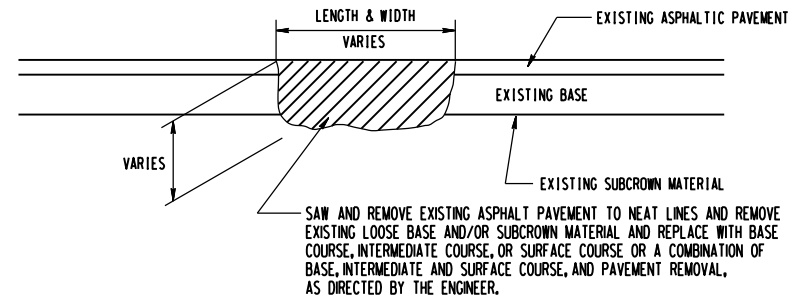

DETAIL NO. 2

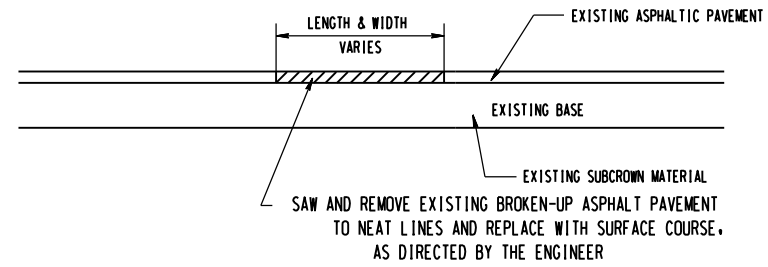

DETAIL NO. 3

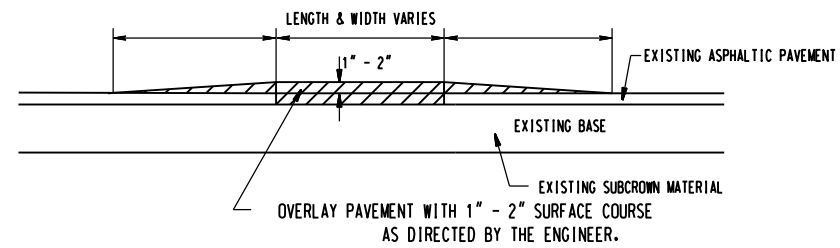

DETAIL NO. 4

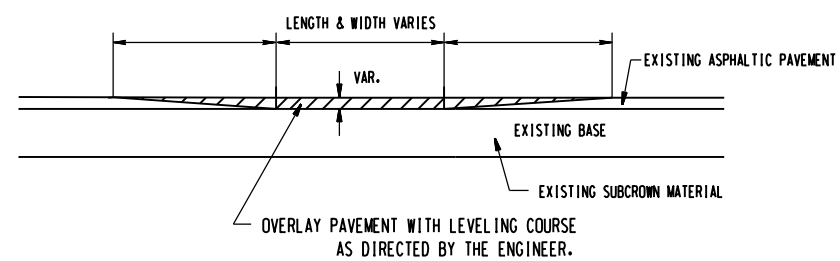

DETAIL NO. 5

REVISIONS

20-APP-2015-1156
 C:\Users\jmkim\OneDrive\Desktop\DETAIL_PSHS\Microsoft\20711173_Patch.dgn
 \$\$\$SYSTRANS\$\$\$

- NOTES:
- 1) DETAIL DOES NOT APPLY TO OGAFC AND ULTRA-THIN BONDED WEARING COURSE.
 - 2) BACKFILL SHOULDER WITH APPROVED MATERIAL.
 - 3) THE SHOULDER WEDGE DEVICE MAY BE DISENGAGED AT PAVED DRIVEWAYS, SIDE STREETS, HIGH SHOULDERS, AND OTHER LOCATIONS NOT FEASIBLE TO CONSTRUCT AS APPROVED BY THE ENGINEER.

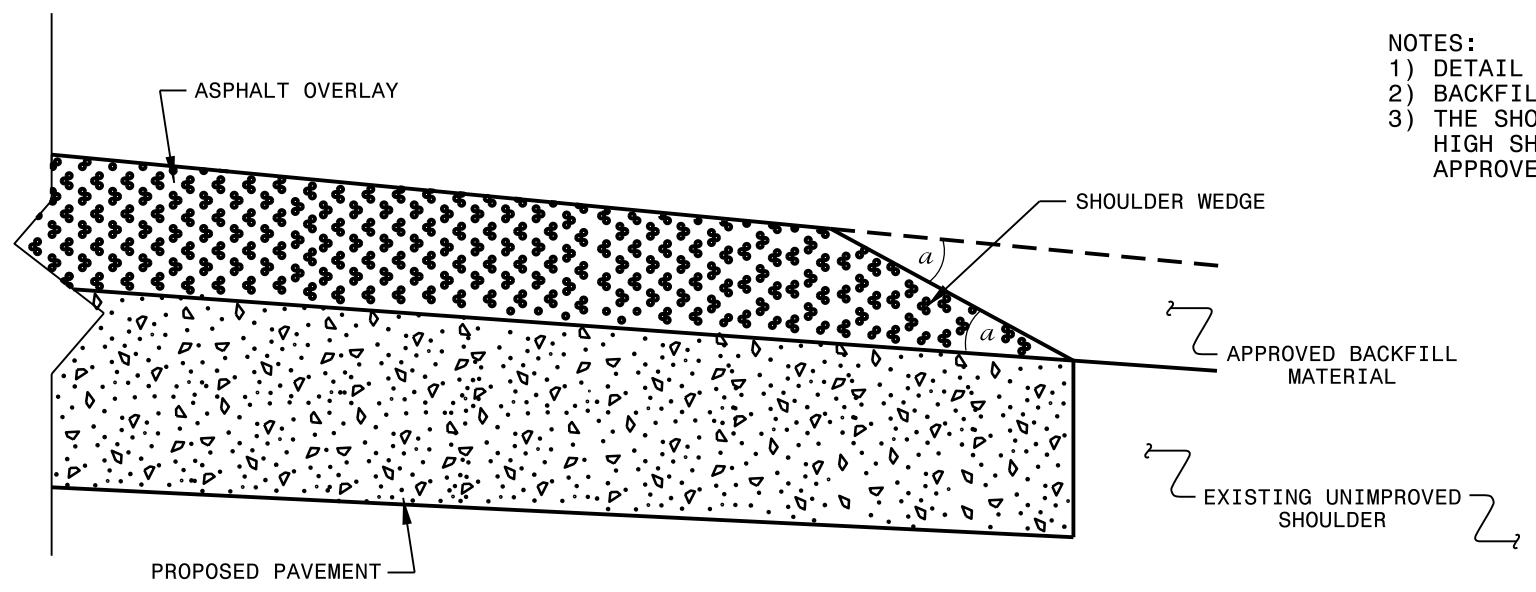

SHOULDER WEDGE DETAIL
 (Resurfacing Projects w/ Widening or
 with Existing Paved Shoulder having no dropoffs)

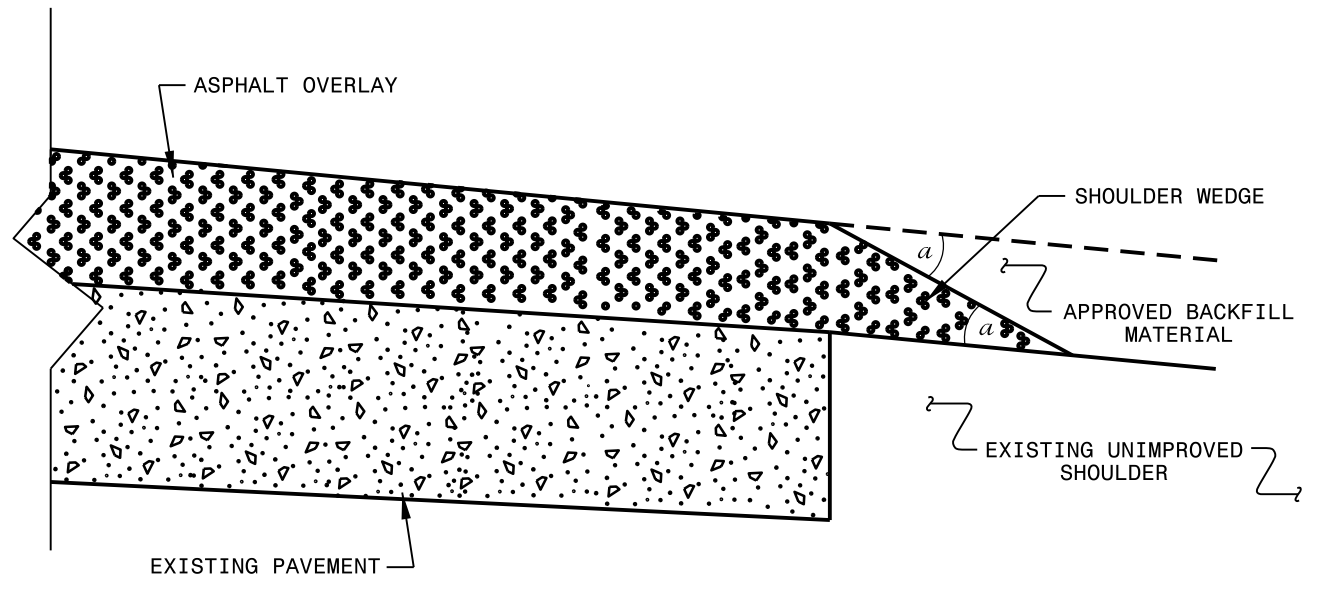

SHOULDER WEDGE DETAIL
 (Resurfacing Projects w/ NO Widening)

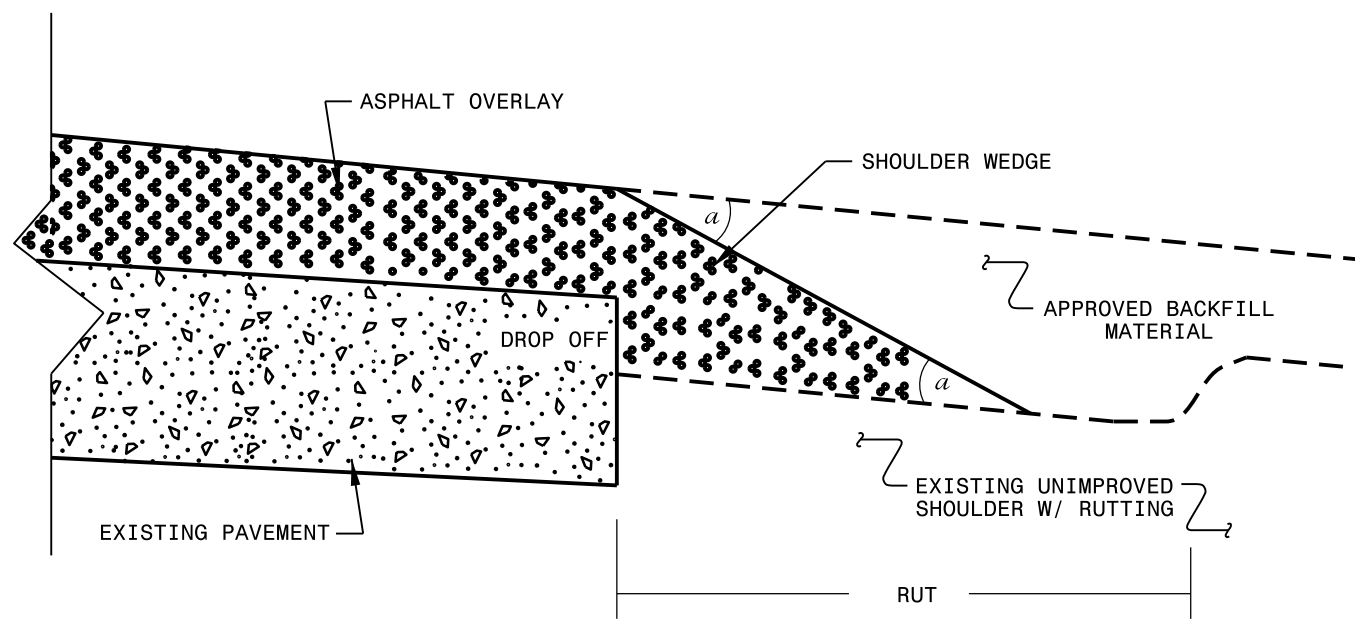

SHOULDER WEDGE DETAIL
 (Resurfacing Adjacent to
 Rutted Shoulder)

- SHOULDER WEDGE ANGLE = 30°

CONTRACT STANDARDS AND DEVELOPMENT UNIT			
Office 919-707-6950		FAX 919-250-4119	
SHOULDER WEDGE DETAILS			
ORIGINAL BY:	T.SPELL	DATE:	7-19-11
MODIFIED BY:		DATE:	2/2/16
CHECKED BY:		DATE:	
FILE SPEC.:	s:\usr\details\stand\shoulderwedgedetail.dgn		

27 JUN 2018 13:22
 s:\usr\details\stand\shoulderwedgedetail.dgn
 3\Sampson August 2018 Revised Shoulder Wedge Detail.dgn
 P:\porter\A1\CSO\2015\2542

DIVISION OF HIGHWAYS
STATE OF NORTH CAROLINA

SOIL STABILIZATION TIMEFRAMES

<i>SITE DESCRIPTION</i>	<i>STABILIZATION TIME</i>	<i>TIMEFRAME EXCEPTIONS</i>
PERIMETER DIKES, SWALES, DITCHES AND SLOPES	7 DAYS	NONE
HIGH QUALITY WATER (HQW) ZONES	7 DAYS	NONE
SLOPES STEEPER THAN 3:1	7 DAYS	IF SLOPES ARE 10' OR LESS IN LENGTH AND ARE NOT STEEPER THAN 2:1, 14 DAYS ARE ALLOWED.
SLOPES 3:1 OR FLATTER	14 DAYS	7 DAYS FOR SLOPES GREATER THAN 50' IN LENGTH.
ALL OTHER AREAS WITH SLOPES FLATTER THAN 4:1	14 DAYS	NONE, EXCEPT FOR PERIMETERS AND HQW ZONES.

NOTES: Less than 5' - 10' undisturbed buffer from ROW, ditchline, water feature, or drainage inlet, add BMP.

BMP Options: Wattle or Silt Fence

EROSION CONTROL DETAIL

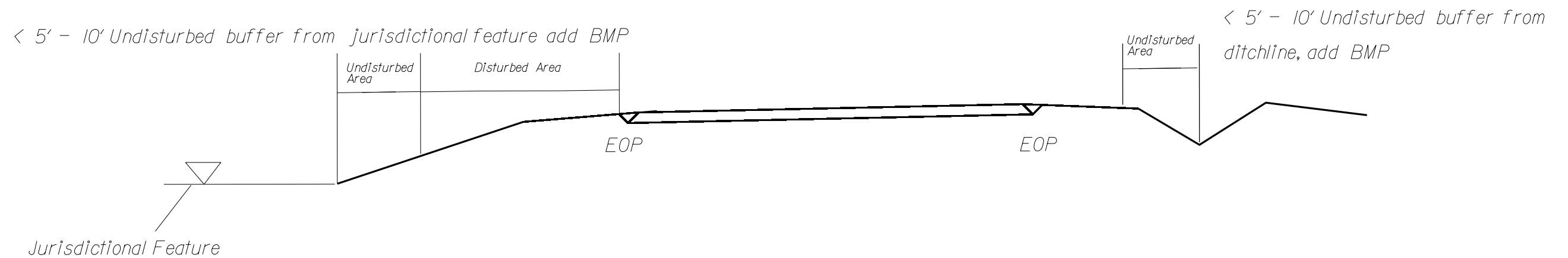
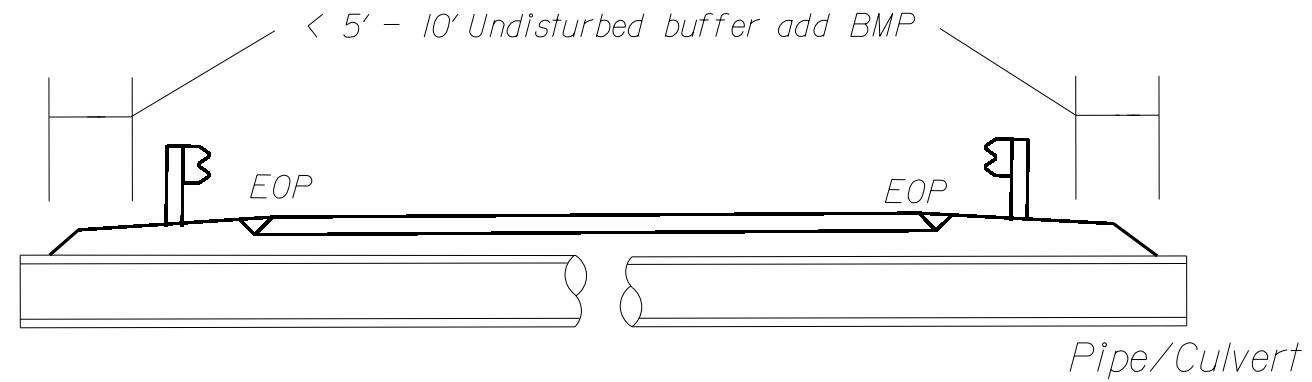

Use BMP's if shoulders and/or frontslopes and/or ditchline and/or backslopes are disturbed

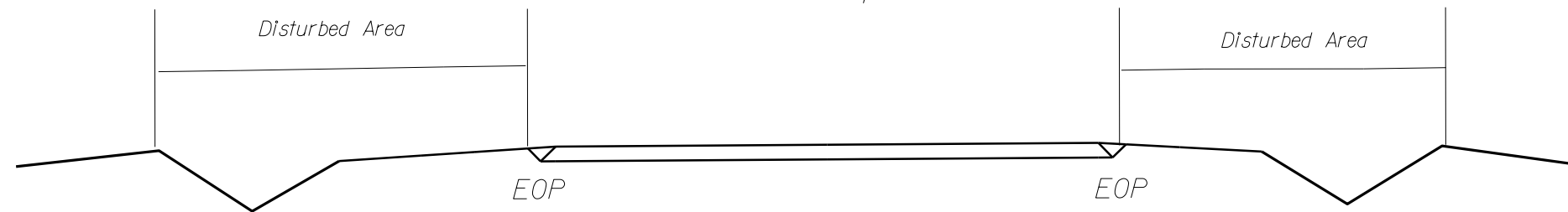

< 5' - 10' Undisturbed buffer from inlet, add wattle

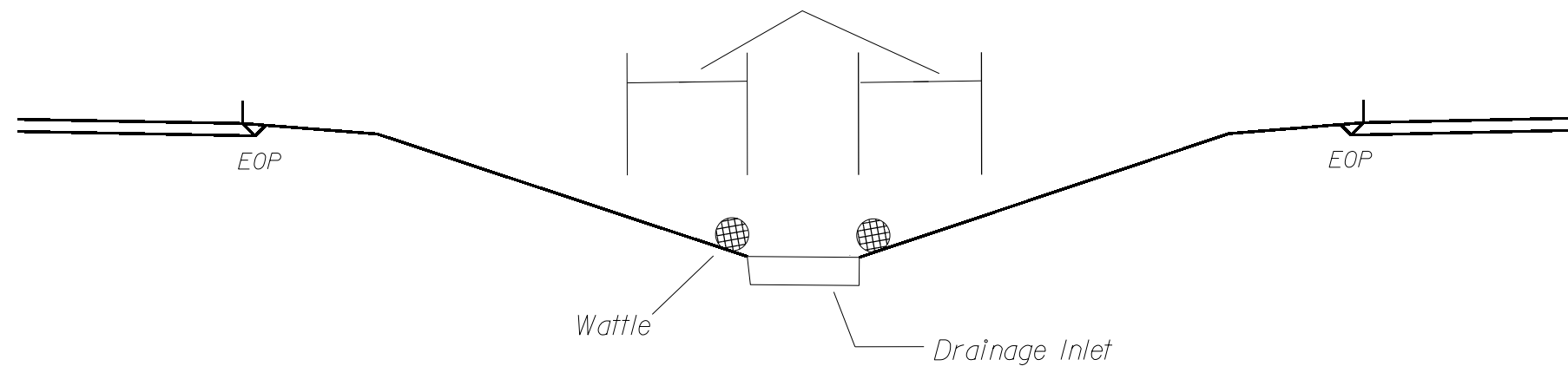

NOT TO SCALE

WATTLE DETAIL

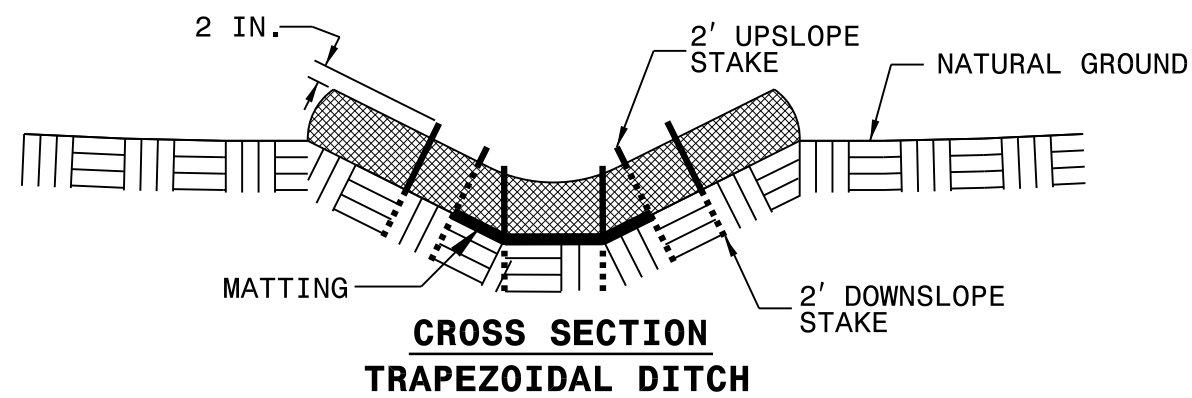
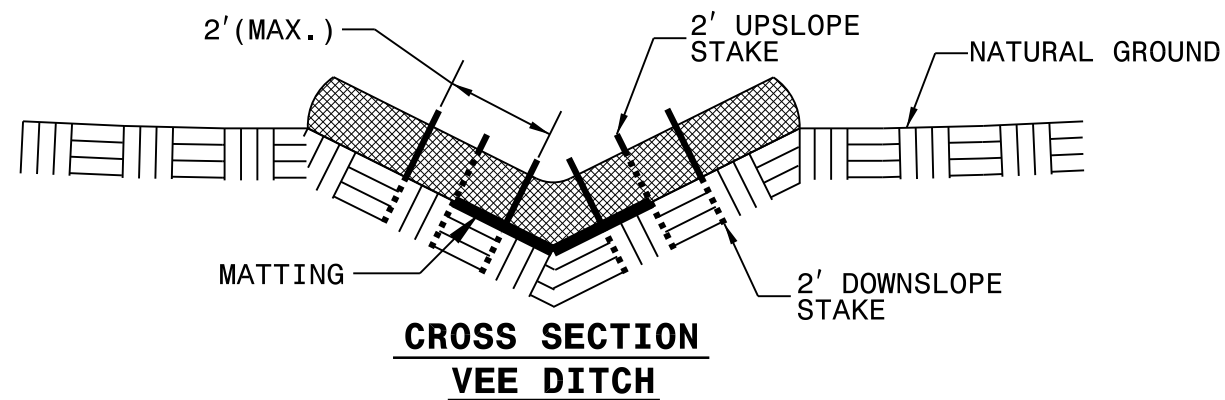
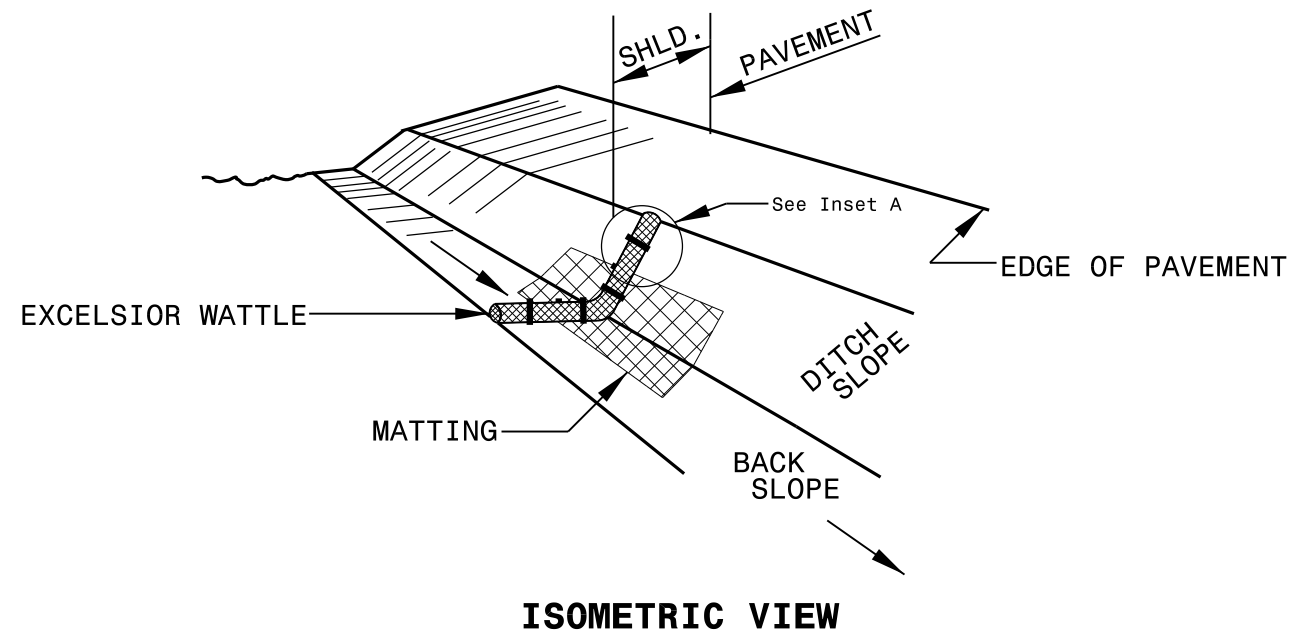

NOTES:

USE MINIMUM 12 IN. DIAMETER EXCELSIOR WATTLE.

USE 2 FT. WOODEN STAKES WITH A 2 IN. BY 2 IN. NOMINAL CROSS SECTION.

ONLY INSTALL WATTLE(S) TO A HEIGHT IN DITCH SO FLOW WILL NOT WASH AROUND WATTLE AND SCOUR DITCH SLOPES AND AS DIRECTED.

INSTALL A MINIMUM OF 2 UPSLOPE STAKES AND 4 DOWNSLOPE STAKES AT AN ANGLE TO WEDGE WATTLE TO BOTTOM OF DITCH.

PROVIDE STAPLES MADE OF 0.125 IN. DIAMETER STEEL WIRE FORMED INTO A U SHAPE NOT LESS THAN 12" IN LENGTH.

INSTALL STAPLES APPROXIMATELY EVERY 1 LINEAR FOOT ON BOTH SIDES OF WATTLE AND AT EACH END TO SECURE IT TO THE SOIL.

INSTALL MATTING IN ACCORDANCE WITH SECTION 1631 OF THE STANDARD SPECIFICATIONS.

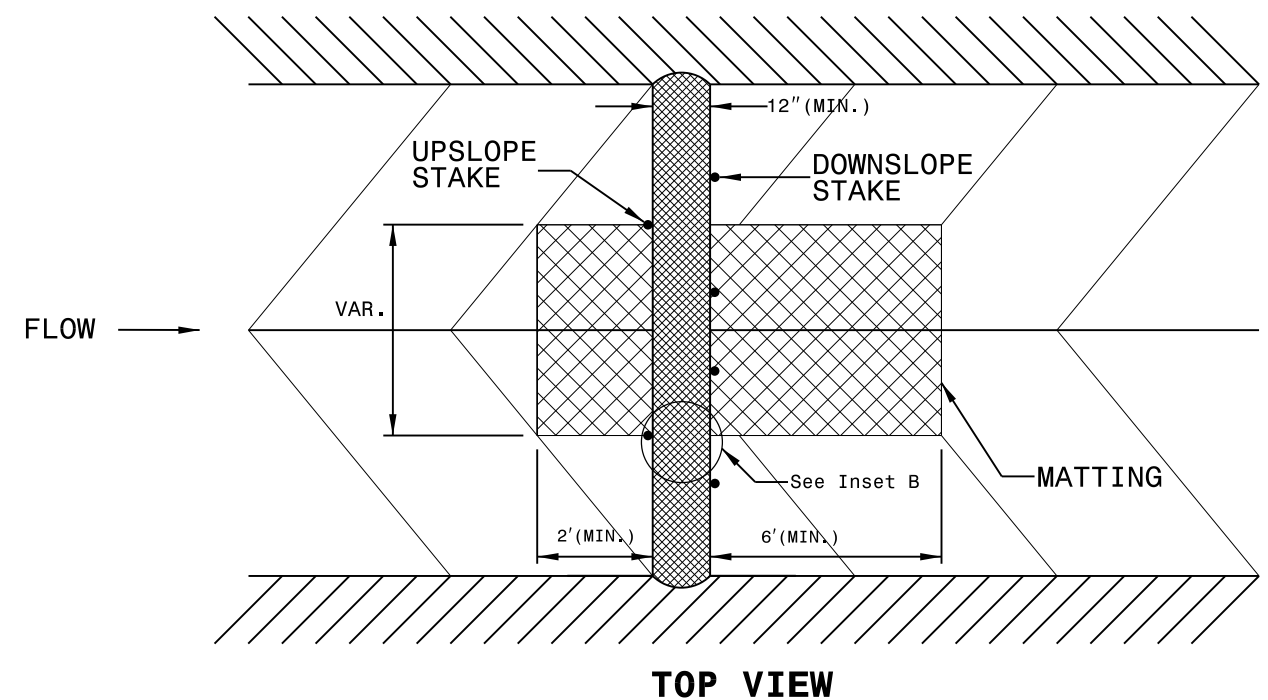
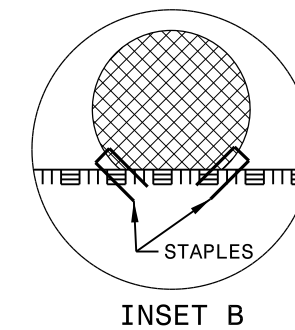
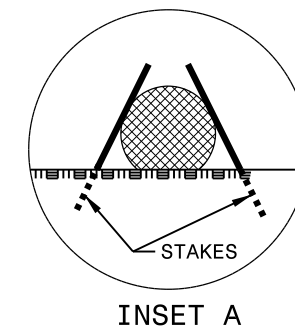

PROJECT NO.	SHEET NO.
2024CPT.03.02.10311, ETC.	5

SUMMARY OF QUANTITIES

PROJECT NO	COUNTY	MAP NO	ROUTE	DESCRIPTION	TYP NO	LANES	LANE TYPE	FINAL SURFACE TESTING REQUIRED	WARM MIX ASPHALT REQUIRED	LENGTH	WIDTH	0234000000-E	0264000000-E	1220000000-E	1297000000-E	1330000000-E	1519000000-E	1523000000-E	1575000000-E	1705500000-E	3150000000-N	3420000000-E		3435000000-N			
												STATE FURNISHED BORROW EXCAVATION	SHOULDER RECONSTRUCTION (STATE FURNISHED BORROW)	INCIDENTAL STONE BASE	1.5" MILLING	INCIDENTAL MILLING	SURFACE COURSE, S9.5B	SURFACE COURSE, S9.5C	ASPHALT BINDER FOR PLANT MIX	PATCHING EXISTING PAVEMENT (MILL)	ADDITIONAL GUARDRAIL POSTS	REMOVE & RESET EXISTING GUARDRAIL (GENERIC)	REMOVE & REPLACE EXISTING GUARDRAIL (GENERIC)	REMOVE & RESET GUARDRAIL END UNIT, TYPE TL-3 (GENERIC)			
												MI	FT	CY	SMI	TON	SY	SY	TON	TON	TON	TON	EA	LF	LF	EA	
2024CPT.03.02.10311	Duplin	1	NC-111	FROM NC 11 TO SR 1306 (OUTLAW BRIDGE RD) [MP 25.74 - MP 32.44]	1,2	2	2WU	NO	NO	6.7	30-38	1,024	13	150	669	792		11,030	687	534	5	150	25	8			
TOTAL FOR MAP NO. 1												6.7		1,024	13	150	669	792		11,030	687	534	5	150	25	8	
TOTAL FOR PROJ NO. 2024CPT.03.02.10311												6.7		1,024	13	150	669	792		11,030	687	534	5	150	25	8	
																						175					
2024CPT.03.02.20311	Duplin	2	SR-1827 / DEEP BOTTOM RD	FROM NC 50 HWY TO NC 41 HWY [MP 6.21 - MP 12.46]	3	2	2WU	NO	NO	6.25	21	955	13	202	21,806	857	8,075		554	270							
TOTAL FOR MAP NO. 2												6.25		955	13	202	21,806	857	8,075		554	270					
2024CPT.03.02.20311	Duplin	3	SR-1546 / BILL SUTTON RD	FROM NC 111 HWY TO SR 1555 (SETH TURNER RD) [MP 0.00 - MP 2.68]	3	2	2WU	NO	NO	2.68	20	409	5	56		222	2,783		193	137							
TOTAL FOR MAP NO. 3												2.68		409	5	56		222	2,783		193	137					
2024CPT.03.02.20311	Duplin	4	SR-1966 / CATHERINE SQUARE RD	FROM SR 1964 (DURWOOD EVANS RD) TO NC 41 HWY [MP 0.00 - MP 1.09]	3	2	2WU	NO	NO	1.09	20	167	2	56		111	1,065		75	74							
TOTAL FOR MAP NO. 4												1.09		167	2	56		111	1,065		75	74					
TOTAL FOR PROJ NO. 2024CPT.03.02.20311												10.02		1,531	20	314	21,806	1,190	11,923		822	481					
GRAND TOTAL												16.72		2,555	33	464	22,475	1,982	11,923		11,030	1,509	1,015	5	150	25	8
																						175					

PROJECT NO.	SHEET NO.
2024CPT.03.02.10311, ETC.	6

SUMMARY OF QUANTITIES

PROJECT NO	COUNTY	MAP NO	ROUTE	DESCRIPTION	TYP NO	LANES	LANE TYPE	FINAL SURFACE TESTING REQUIRED	WARM MIX ASPHALT REQUIRED	LENGTH		WIDTH		6009000000-E	6012000000-E	6015000000-E	6018000000-E	6021000000-E	6036000000-E	6042000000-E	6071010000-E	6084000000-E	6090000000-E	6093000000-E	6117000000-N						
										MI	FT	STONE FOR EC CLASS B	SEDIMENT CONTROL STONE	TEMPORARY MULCHING	SEED FOR TEMPORARY SEEDING	FERTILIZER FOR TEMPORARY SEEDING	MATting FOR EROSION CONTROL	1/4" HARDWARE CLOTH	WATTLE	SEED & MULCHING	SEED FOR REPAIR SEEDING	FERTILIZER FOR REPAIR SEEDING	RESPONSE FOR EROSION CONTROL								
														TON	TON	ACR	LBS	TON	SY	LF	LF	AC	LB	TON	EA						
2024CPT.03.02.10311	Duplin	1	NC-111	FROM NC 11 TO SR 1306 (OUTLAW BRIDGE RD) [MP 25.74 - MP 32.44]	1,2	2	2WU	NO	NO	6.7	30-38			168	168	6.70	335	1.70	50	335	110	6.50	335	1.70	14						
TOTAL FOR MAP NO. 1																															
TOTAL FOR PROJ NO. 2024CPT.03.02.10311																															
2024CPT.03.02.20311	Duplin	2	SR-1827 / DEEP BOTTOM RD	FROM NC 50 HWY TO NC 41 HWY [MP 6.21 - MP 12.46]	3	2	2WU	NO	NO	6.25	21			156	156	6.00	315	2.00	40	315	100	6.00	315	2.00	12						
TOTAL FOR MAP NO. 2																															
2024CPT.03.02.20311	Duplin	3	SR-1546 / BILL SUTTON RD	FROM NC 111 HWY TO SR 1555 (SETH TURNER RD) [MP 0.00 - MP 2.68]	3	2	2WU	NO	NO	2.68	20			70	79	3.00	135	0.10	20	135	50	2.00	135	1.00	5						
TOTAL FOR MAP NO. 3																															
2024CPT.03.02.20311	Duplin	4	SR-1966 / CATHERINE SQUARE RD	FROM SR 1964 (DURWOOD EVANS RD) TO NC 41 HWY [MP 0.00 - MP 1.09]	3	2	2WU	NO	NO	1.09	20			27	27	1.00	55	0.25	10	55	20	1.00	55	0.25	2						
TOTAL FOR MAP NO. 4																															
TOTAL FOR PROJ NO. 2024CPT.03.02.20311																															
GRAND TOTAL																															
														16.72			421	430	16.70	840	4.05	120	840	280	15.50	840	4.95	33			

PROJECT NO.	SHEET NO.
2024CPT.03.02.10311, ETC.	7

THERMOPLASTIC AND PAINT QUANTITIES

PROJECT NO	COUNTY	MAP NO	ROUTE	DESCRIPTION	TYP NO	LANES	LANE TYPE	LENGTH	WIDTH	4413000000-E	4457000000-N	4685000000-E		4695000000-E	4709000000-E	4725000000-E	4810000000-E		4850000000-E	4870000000-E	4900000000-N	4905100000-N	
										WORK ZONE ADVANCE/GENERAL WARNING SIGNING	TEMPORARY TRAFFIC CONTROL	4" X 90 M YELLOW THERMO	4" X 90 M WHITE THERMO	8" X 90 M YELLOW THERMO	THERMOPLASTIC PAVEMENT MARKING LINES (24" X 90 MILS)	THERMO LT ARROW (90 MIL)	4" WHITE PAINT	4" YELLOW PAINT	REMOVAL OF PAVEMENT MARKING LINES (4")	REMOVAL OF PAVEMENT MARKING LINES (24")	YELLOW & YELLOW MARKERS	NON CAST IRON SNOWPLOWABLE MARKERS (Y/Y)	
									MI	FT	SF	LS	LF	LF	LF	EA	LF	LF	LF	LF	EA	EA	
2024CPT.03.02.10311	Duplin	1	NC-111	FROM NC 11 TO SR 1306 (OUTLAW BRIDGE RD) [MP 25.74 - MP 32.44]	1,2	2	2WU	6.7	30-38	750	0.40	42,221	69,190	200	120	7				120		442	
TOTAL FOR MAP NO. 1									6.7		750	0.40	42,221	69,190	200	120	7				120		442
TOTAL FOR PROJ NO. 2024CPT.03.02.10311									6.7		750	0.40	42,221	69,190	200	120	7				120		442
												111,411											
2024CPT.03.02.20311	Duplin	2	SR-1827 / DEEP BOTTOM RD	FROM NC 50 HWY TO NC 41 HWY [MP 6.21 - MP 12.46]	3	2	2WU	6.25	21	700	0.37	43,073	64,805				1,280	1,280	1,280		415		
TOTAL FOR MAP NO. 2									6.25		700	0.37	43,073	64,805				1,280	1,280	1,280		415	
2024CPT.03.02.20311	Duplin	3	SR-1546 / BILL SUTTON RD	FROM NC 111 HWY TO SR 1555 (SETH TURNER RD) [MP 0.00 - MP 2.68]	3	2	2WU	2.68	20	300	0.16	15,296	27,698								185		
TOTAL FOR MAP NO. 3									2.68		300	0.16	15,296	27,698								185	
2024CPT.03.02.20311	Duplin	4	SR-1966 / CATHERINE SQUARE RD	FROM SR 1964 (DURWOOD EVANS RD) TO NC 41 HWY [MP 0.00 - MP 1.09]	3	2	2WU	1.09	20		0.07	2,322	10,994								70		
TOTAL FOR MAP NO. 4									1.09			0.07	2,322	10,994									70
TOTAL FOR PROJ NO. 2024CPT.03.02.20311									10.02		1,000	0.60	60,691	103,497				1,280	1,280	1,280		670	
												164,188											
												275,599											
GRAND TOTAL									16.72		1,750	1	102,912	172,687	200	120	7	1,280	1,280	1,280	120	670	442
												275,599											
												2,560											

SIGNING FOR RESURFACING PROJECTS

LEGEND

┆ STATIONARY SIGN

← DIRECTION OF TRAFFIC FLOW

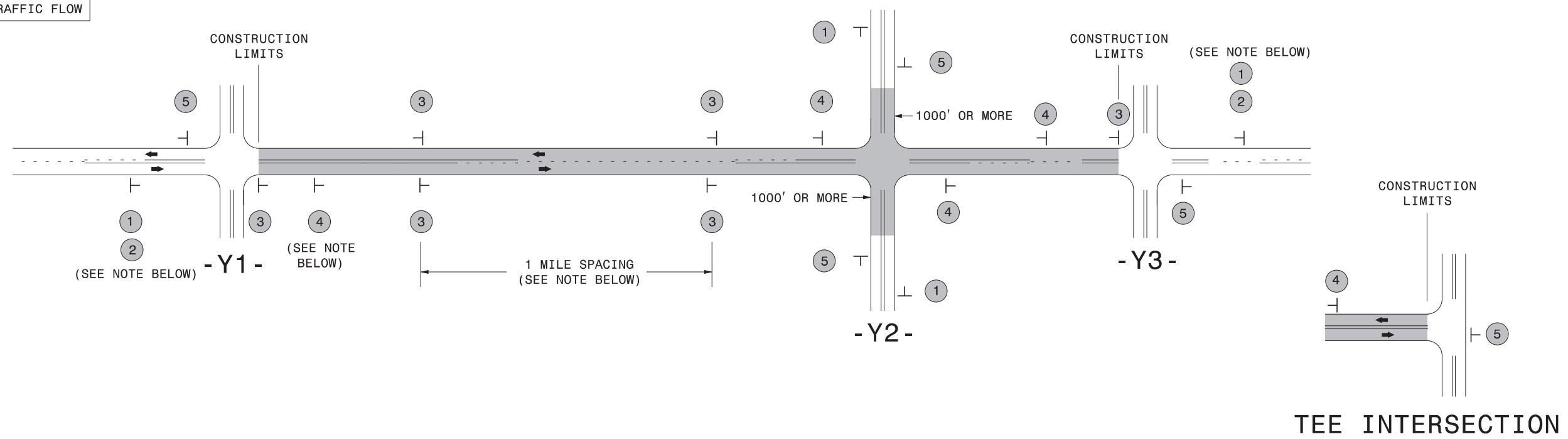

SIGNING NOTES AND PLACEMENT PER DIRECTION	1	 <small>W20-1 48" X 48"</small>	PLACE 1000' PRIOR TO BEGINNING OF CONSTRUCTION LIMITS. ONLY USED ON -Y- LINES IF RESURFACING LIMITS EXTEND 1000' ALONG -Y- LINE.
	2	 <small>W7-3aP 24" X 18"</small>	#2 SIGN ONLY USED WHEN CONSTRUCTION LIMITS ARE 2 OR MORE MILES IN LENGTH. ROUND UP TO NEXT WHOLE NUMBER. (NO FRACTIONAL OR DECIMAL NUMBERS)
	3	 <small>SP 13107 48" X 48"</small>	- PLACE INITIALLY AT THE CONSTRUCTION LIMITS AND SPACE 1 MILE APART THEREAFTER. - AT TEE INTERSECTIONS INSTALL INITIALLY 1/2 MILE FROM INTERSECTION AND SPACE 1 MILE APART THEREAFTER.
	4	 <small>SP 13106 48" X 48"</small>	- THESE ARE FOR -Y- LINES THAT ARE "THROUGH" ROADWAYS. - DEAD END AND SUBDIVISION ROADS ARE NOT "THROUGH" ROADWAYS. - INSTALL 500' +/- FROM EACH -Y- LINE APPROACH AS SHOWN ABOVE. - FOR MULTIPLE -Y- LINES THAT ARE SEPARATED BY 0.25 MILES OR LESS, TREAT AS A SINGLE UNIT AND INSTALL WITHIN 500' OF EACH APPROACH. - A MAXIMUM OF 2 SIGN SETS PER MILE. DO NOT INSTALL WHEN -Y- LINES ARE WITHIN 0.5 MILES FROM "END ROAD WORK" SIGN. - FOR TEE INTERSECTIONS, INSTALL WITHIN 500' +/- OF THE INTERSECTION ALONG -L- LINE.
	5	 <small>G20-2 A 48" X 24"</small>	PLACE 500' FOLLOWING THE END OF CONSTRUCTION LIMITS OR AS SHOWN WHEN WORK ENDS AT A 3-WAY TEE INTERSECTION.

NO REQUIRED STATIONARY SIGNING FOR THE FOLLOWING -Y- LINE CONDITIONS:

- 1) LESS THAN 1000' OF RESURFACING ALONG -Y- LINE
- 2) SUBDIVISION ROADS
- 3) DEAD END ROADS

WHEN PAVING/CONSTRUCTION ACTIVITIES PROCEED ACROSS AN UNSIGNED -Y- LINE, PORTABLE ADVANCE WARNING SIGNS SHALL BE USED ALONG THE -Y- LINE AS SHOWN BELOW. REMOVE UPON COMPLETION OF WORK.

 <small>W20-1 48" X 48"</small> PLACED 500' IN ADVANCE OF FLAGGER.	 <small>W20-7 A 48" X 48"</small> PLACED 250' IN ADVANCE OF FLAGGER.
--	--

THE ABOVE SIGNS ARE ALL THAT ARE REQUIRED FOR A CONTRACTOR TO BEGIN A RESURFACING CONTRACT. ANY ADDITIONAL SIGNS REQUESTED BY NCDOT DIVISIONS SHALL BE INSTALLED WITHIN 7 BUSINESS DAYS OF THE START OF CONTRACT WORK.

MAPS LESS THAN 2 MILES

FOR RESURFACING MAPS WITH CONSTRUCTION LIMITS LESS THAN 2 MILES IN LENGTH, NO STATIONARY SIGNS ARE REQUIRED. USE PORTABLE "ROAD UNDER CONSTRUCTION" OR "ROAD WORK AHEAD" SIGNS IN LIEU OF STATIONARY ADVANCE WARNINGS SIGNS.

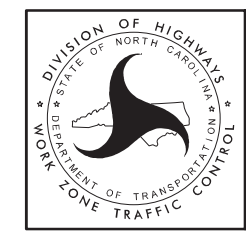

ADVANCE WARNING SIGNS FOR RURAL AND SUBURBAN 2-LANE ROADWAY RESURFACING